

Product description	<b>M12 Male panel mount connector, Contacts: 4+FE, unshielded, THR, IP67, UL, M16x1.5</b>
Area	<b>M12-L</b>
Part no.	<b>99 0641 20 05</b>

### Illustration

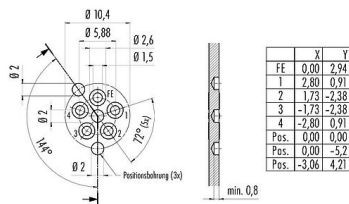

## Conductor layout



### Scale drawing

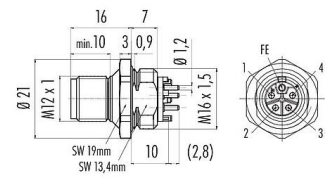

### Contact arrangement (Plug-in side)

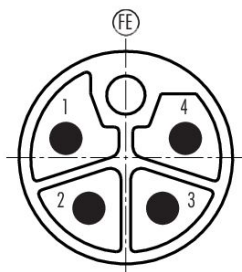

**You can find the assembly instructions on the next page.**

## Technical data

## General features

Part no.	99 0641 20 05
Connector design	Male panel mount connector
Type standard	DIN EN IEC 61076-2-111:2018-10;VDE 0687-76-2-111:2018-10
Version	Connector pin straight
Connector locking system	M12x1
Termination	THR
Degree of protection	IP67

Product description	M12 Male panel mount connector, Contacts: 4+FE, unshielded, THR, IP67, UL, M16x1.5
Area	M12-L
Part no.	99 0641 20 05

Temperature range from/to	-40 °C / 105 °C
Mechanical operation	> 100 Mating cycles
Weight (g)	15.16
Customs tariff number	85369010
Country of Origin	DE

### Electrical parameters

Rated voltage	63 V
Rated impulse voltage	1500 V
Rated current	16.0 A
Insulation resistance	> 10 <sup>10</sup> Ω
Pollution degree	3
Overvoltage category	III
Insulating material group	I
EMC compliance	unshielded

### Material

Housing material	Zinc die-cast nickel-plated
Contact body material	PA (UL94 V-0)
Contact material	CuZn (brass) / CuSn (bronze)
Contact plating	Au (gold)
Locking material	Zinc die-cast nickel-plated
REACH SVHC	CAS 7439-92-1 (Lead)
SCIP number	dd185b76-ba4b-4ead-9ac2-b26394a53d09

### Authorization/approvals

Approvals	UL
-----------	----

### Classifications

eCl@ss 11.1	27-44-01-02
ETIM 9.0	EC002635

# Product data sheet

## Automation technology - Voltage and Power Supply



Product description **M12 Male panel mount connector, Contacts: 4+FE, unshielded, THR, IP67, UL, M16x1.5**

Area **M12-L**

Part no. **99 0641 20 05**

### Assembly instructions / Panel cut-out

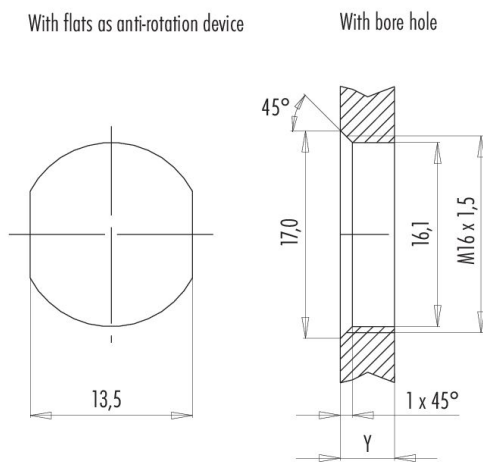

Installation direction: o-ring sits on chamfer.

#### Tightening moment

Metall housing/Plastic housing 1,25 Nm

Thickness of wall Y (mm)		
Version	min (mm)	max (mm)
Fastened from rear	2	3,5
Front fastened	2	4,5
positioning possible <sup>1)</sup>	2	3,5
Screw clamp	2	3,5
Thread M12 x 1	2	3,0
Thread M14 x 1 <sup>2)</sup>	<sup>3)</sup> 1,5/ <sup>4)</sup> 2	6,5

#### Notes

<sup>1)</sup> Do not attach a chamfer

<sup>2)</sup> Wall thickness:

use nut 38 5385 100 001 up to 1,5 mm,  
>1,5 mm cut thread

<sup>3)</sup> Nut

<sup>4)</sup> Thread in wall of housing

Product description	<b>M12 Male panel mount connector, Contacts: 4+FE, unshielded, THR, IP67, UL, M16x1.5</b>
Area	<b>M12-L</b>
Part no.	<b>99 0641 20 05</b>

### Security notices

The connector must not be plugged or unplugged under load. Non-observance and improper use can result in personal injury.

The connectors have been developed for applications in plant engineering, control and electrical equipment construction. The user is responsible for checking whether the connectors can also be used in other areas of application.

Plug connectors with enclosure protection IP67 and IP68 are not suitable for use under water. When used outdoors, the plug connectors must be protected separately against corrosion. For further information on the IP protection classes, please refer to the "Technical Information" download centre.

To lock the cable connector with the device connector, the threaded ring is tightened "hand-tight" (approx. 60 cNm).